



Lifting Points - for bolting -

# PowerPoint<sup>®</sup> Star

...360° swivelling - PP-S -



**4 SAFETY FACTOR 4:1**  
LOADABLE IN ANY DIRECTION



▲ Gauge marks to determine overload

Complies with the machinery directives 2006/42/EG

### PowerPoint-Star - PP-S -

- Double ballbearing for free turning and soft winding
- Suitable for all lifting/lashing means for example hooks, rings and slings.
- **Non-protruding hook tip**
- Forged safety latch, engages in the tip of the hook therefore protected against lateral bending.
- Triple coiled corrosion protected double leg spring
- Thickened tip of the hook prevents handling malpractices and resists bending.
- Wearing edges on both sides and gauge marks for measuring the width of the hook opening.
- Not suitable for permanent swivelling under load
- Even under full load, can be turned in a 90° position from the bolt centre line.

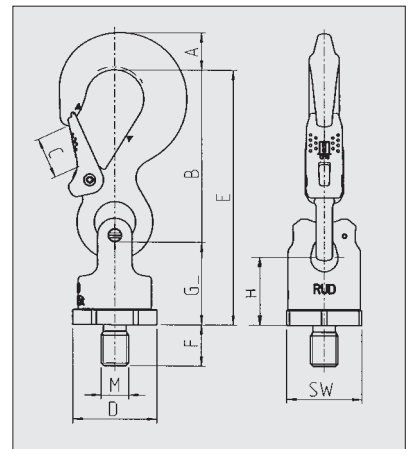
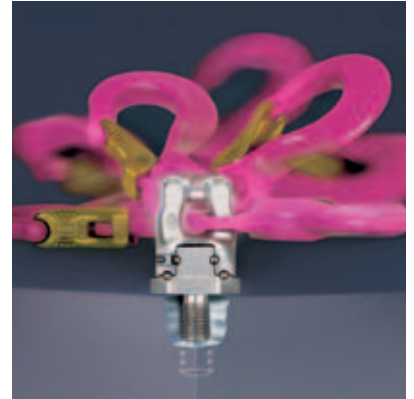

Type	WLL (t)	A	B	C	D	E	F Standard	F Vario	G	H	M	SW	Weight (kg)	Torque	Ref.-No. (Standard)	Ref.-No. (Vario)
PP-S-0.63t-M12	0.63	13	75	18	40	116	18	12-140	41	33	12	36	0.4	According to the user instructions	7990719	8600320
PP-S-1.5t-M16	1.5	20	97	25	46	147	24	16-180	50	40	16	41	1.0		7989719	8600321
PP-S-2.5t-M20	2.5	28	126	30	61	187	30	20-223	61	47	20	55	1.7		7989075	8600322
PP-S-4t-M24	4.0	36	150	35	78	227	36	24-255	77	60	24	70	3.2		7989076	8600323
PP-S-5t-M30	5.0(6.7)	37	174	40	95	267	45	30-330	93	71	30	85	7.2		7989720	8600324
PP-S-8t-M36	8.0(10)	49	208	48	100	310	54	36-300	102	76	36	90	9.2		7989077	8600305
PP-S-0.63t-1/2"-13UNC	0.63	13	75	18	40	116	18	-	41	33	1/2"	36	0.4	According to the user instructions	7990720	8600320
PP-S-1.5t-5/8"-11UNC	1.5	20	97	25	46	147	24	16-55	50	40	5/8"	41	1.0		7989908	8600321
PP-S-2.5t-3/4"-10UNC	2.5	28	126	30	61	187	30	19-65	61	47	3/4"	55	1.7		7989909	8600322
PP-S-2.5t-7/8"-9UNC	2.5	28	126	30	61	187	30	-	61	47	7/8"	55	1.7		7989910	8600323
PP-S-4t-1"-8UNC	4.0	36	150	35	78	227	36	25-74	77	60	1"	70	3.2		7989911	8600323
PP-S-5t-1 1/4"-7UNC	5.0(6.7)	37	174	40	95	267	45	31-91	93	71	1 1/4"	85	7.2		7989912	8600324

( ) increased WLL at axial load direction

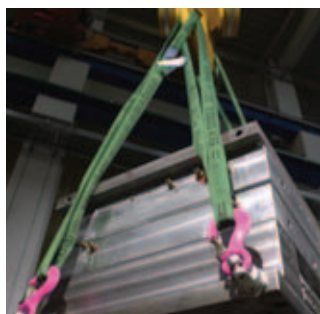

Subject to technical alternations!